

# Innovative new product! It has locking function for rotation

Compact rotary unit is available now due to original locking structure.  
Safety can be realized by position locking in the case of off-running of rotary actuator and servo motor, or power failure or emergency.



## Rotary lock unit <RTL Series>

**CKD Corporation**

<http://www.ckd.co.jp/>

CC-978A

●This product is custom order with our sales office contact consult with CKD.

## Sales point ②

Rotary lock is suitable for position locking toward rotating direction in the case of off-running of rotary actuator and servo motor, or power failure or emergency.  
Lock torque (5 Series)  
3.88N·m to 68N·m

## Sales point ③

Free-selection for locking way by reversal setting.  
A bi-directional lock is also possible!!  
(When using 2 pc.)

## Sales point ①

Unlocked realized depending on original structure (PATENT.PEND) at ultra thin and low operating force!!

## Sales point ④

Corresponding option to Selex Rotary(RV3 $\bar{S}$ 20 to RV3 $\bar{S}$ 300)c/w safety locking.  
To be installed later is also possible.

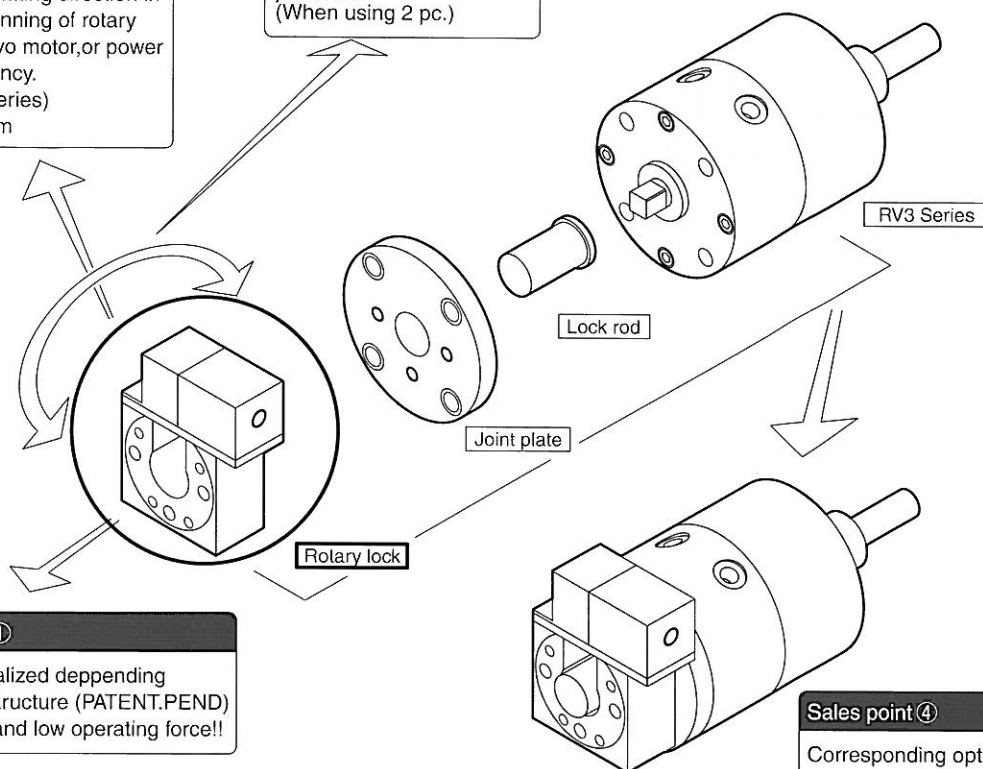

- ◇ Ingenious structure(PATENT. PEND) by super-thin type, and it makes easy locking release by low control force.
- ◇ Wide variations corresponding with required lock torque.
- ◇ Available both way locking and free-selection by reversal setting.
- ◇ Corresponding option for RV3※ series c/w safety locking, and available to install later.

## Main specifications

Model	RTL-12	RTL-16	RTL-20	RTL-30	RTL-35
Subject rod diameter (ømm)	12f <sub>8</sub>	16f <sub>8</sub>	20f <sub>8</sub>	30f <sub>8</sub>	35f <sub>8</sub>
Working fluid	Compressed air				
Max. working pressure (Mpa)	0.7				
Min. working pressure (Mpa)	0.3				
Withstanding pressure proof (Mpa)	1.05				
Ambient temperature (°C)	-5 to 60 (no freezing)				
Port size	M5				
Lock torque (N·m)	3.88	7.7	10.4	35	68
Backlash + elasticity deforming angle	3° to max8° (allowable max. torque)				
Subject rotary actuator	RV3*20	RV3*30	RV3*50	RV3*150	RV3*300

本製品及び関連技術を輸出される場合は、兵器・武器関連用途に使用されるおそれのないよう、ご留意ください。

If the goods and their replicas, or the technology and software in this catalog are to be exported, laws require the exporter to make sure they will never be used for the development or the manufacture of weapons for mass destruction.

## CKD Corporation

<Website>

<http://www.ckd.co.jp/>

本社・工場  
営業本部  
Overseas Sales dept.  
東京支店  
名古屋支店  
大阪支店

〒485-8551 愛知県小牧市広時2-250  
〒485-8551 愛知県小牧市広時2-250  
2-250 Oujii Komaki, Aichi 485-8551, Japan  
〒105-0013 東京都港区浜松町1-31-1 (文化放送メディアプラス4階)  
〒485-8551 愛知県小牧市広時2-250  
〒550-0001 大阪府西区土佐堀1-3-20

TEL(0568)77-1111 FAX(0568)77-1123  
TEL(0568)74-1303 FAX(0568)77-3410  
TEL(0568)74-1338 FAX(0568)77-3461  
TEL(03)5402-3620 FAX(03)5402-0120  
TEL(0568)74-1356 FAX(0568)77-3317  
TEL(06)6459-5770 FAX(06)6446-1945

●このカタログに掲載の仕様および外観を、改善のため予告なく変更することがあります。

●Specifications are subject to change without notice.

© CKD Corporation 2009 All copy rights reserved.

2009.3.CCC